

10

11

12

13

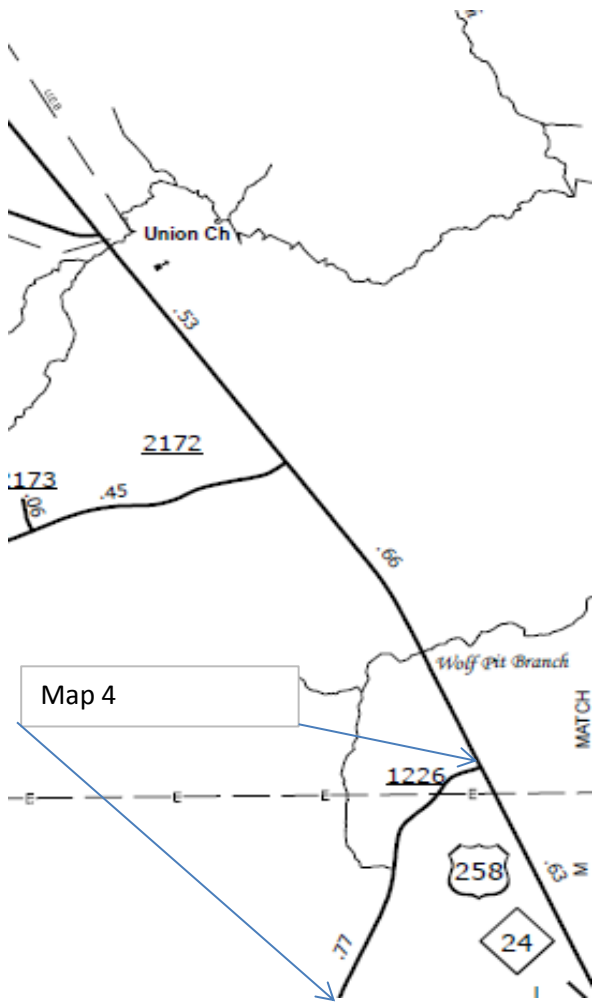

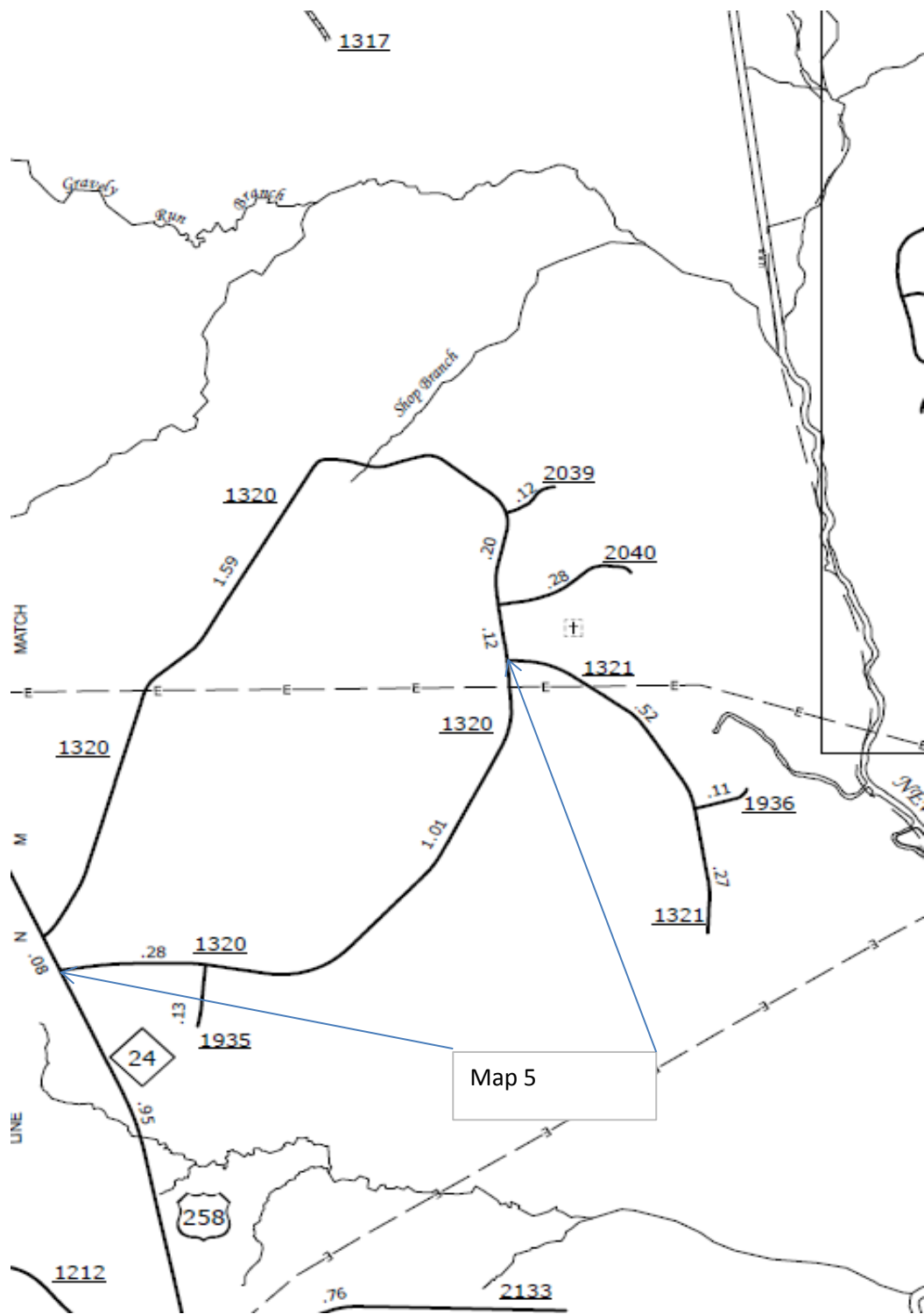

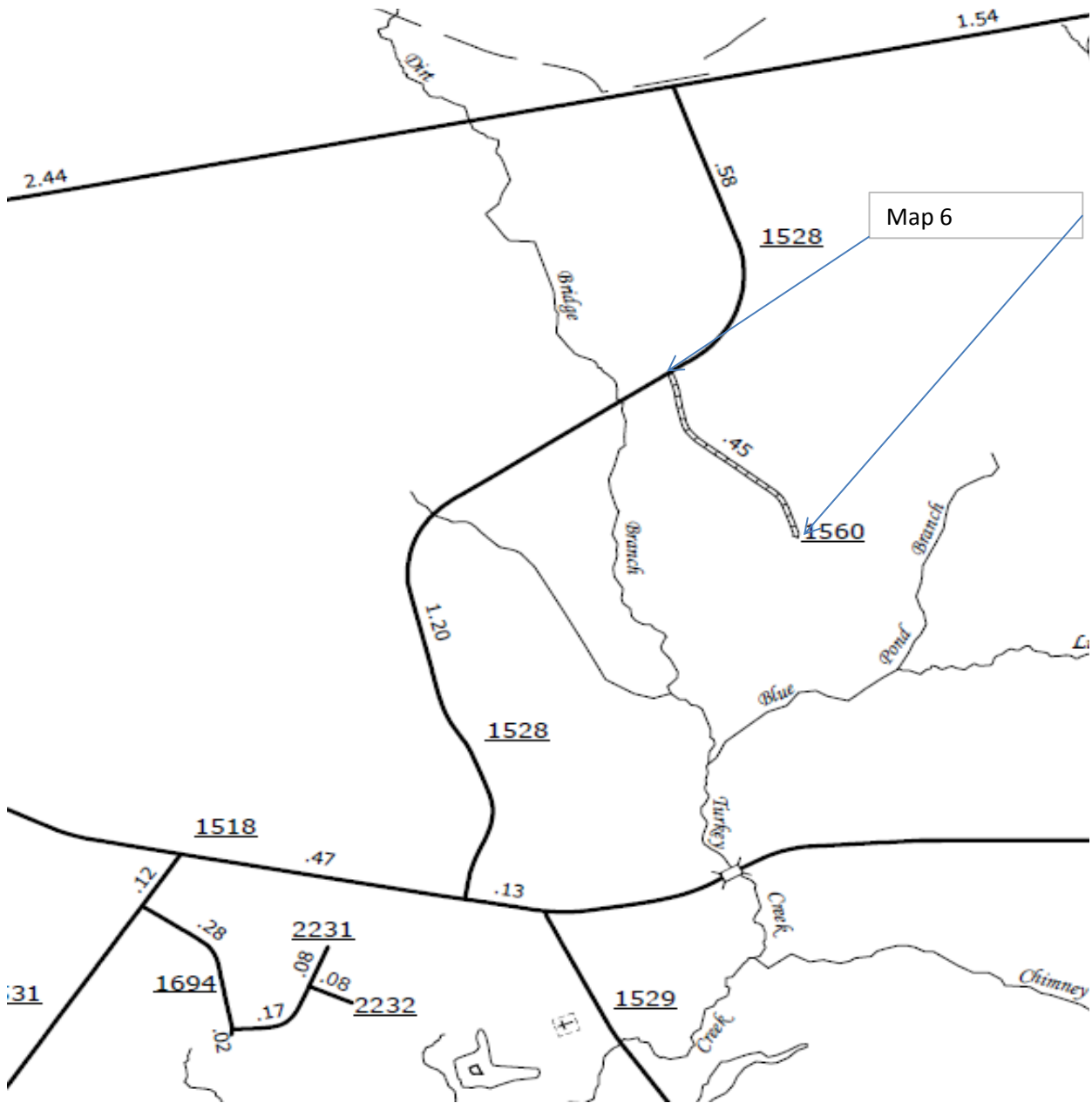



ukes



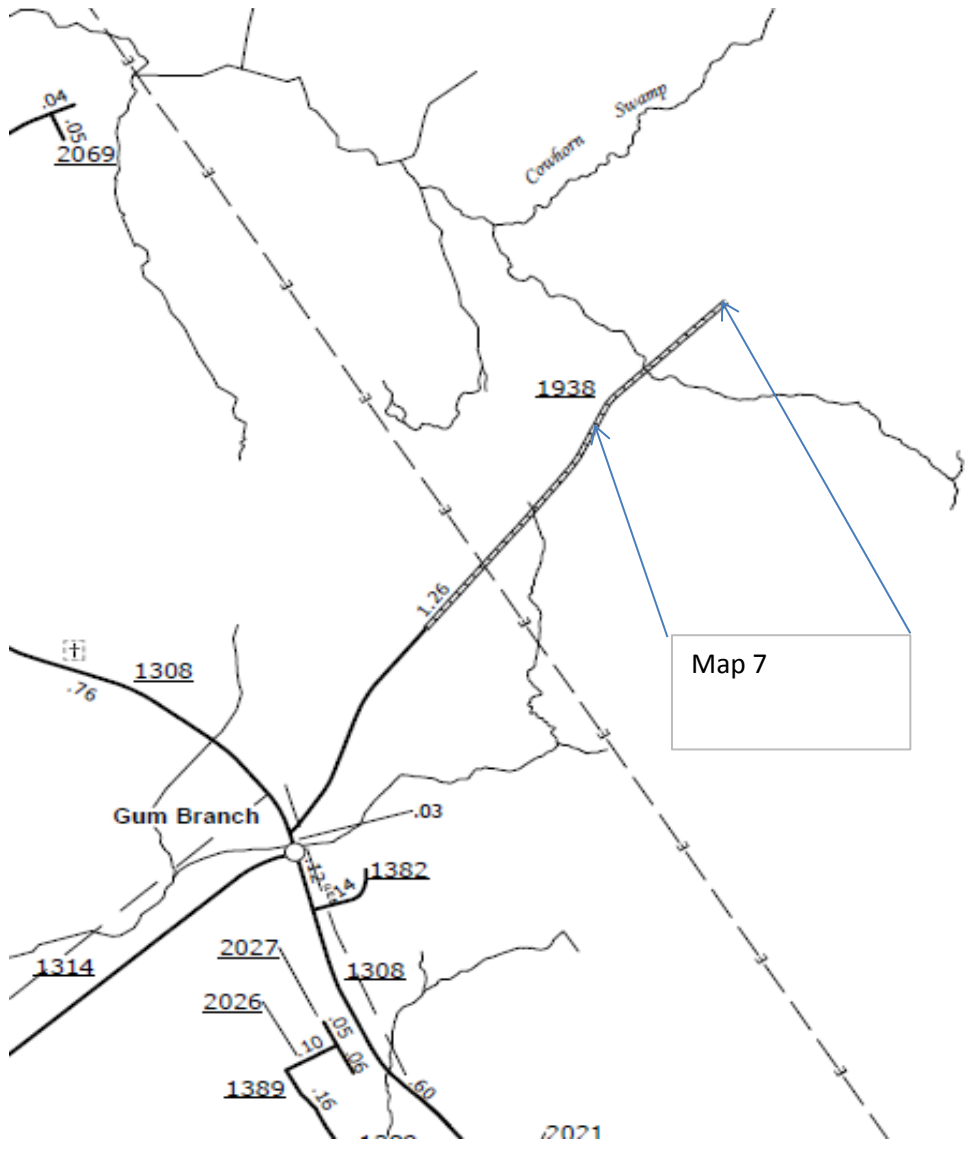

Map 7

TYPICAL SECTIONS

WBS ELEMENT 38307, 3CR.20671.172, 3C.067076 & 3C.067078

MAP NO. 1, 2 & 3

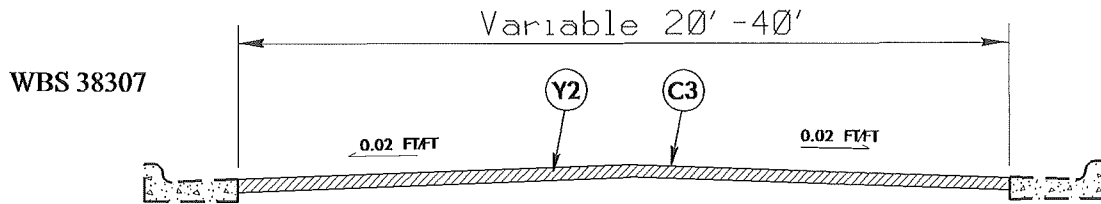

TYPICAL SECTION NO. 1

USE FOR SR 1003 & SR 1308
From US 258 to Elizabeth Avenue ON SR 1003
and SR 1308 FROM DRIVEWAY TO END PROJECT

MAP NO. 2

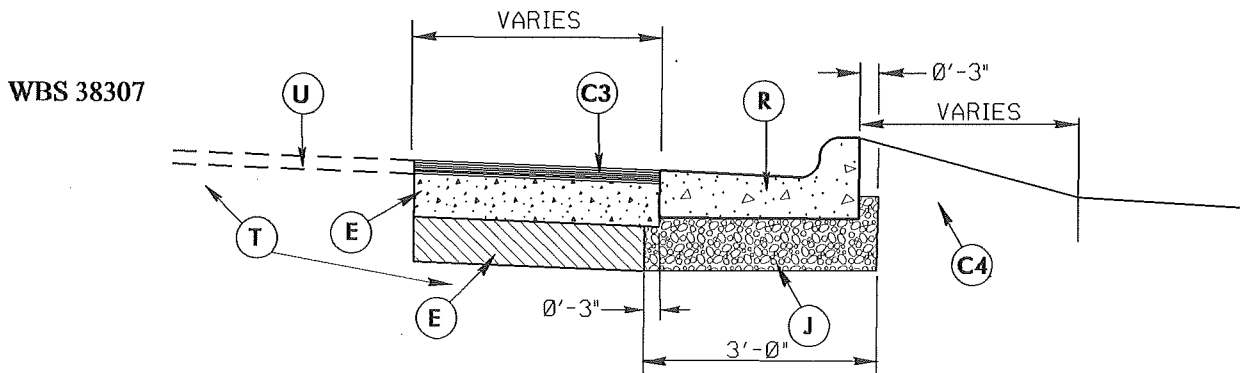

TYPICAL SECTION NO. 2

WIDENING FOR RIGHT TURN ON SR 1003 & SR 1308

TYPICAL SECTIONS

WBS ELEMENT 38307, 3CR.20671.172,

3C.067076 & 3C.067078

MAP NO. 4

WBS 3CR.20671.172

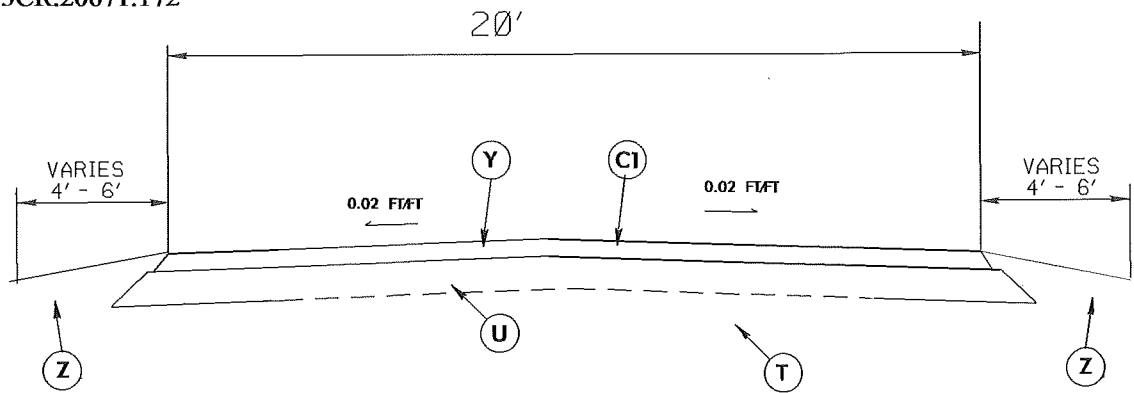

TYPICAL SECTION NO. 3

USE ON SR 1226 FROM US 258 TO STATION 35+90

MAP NO. 4

WBS 3CR.20671.172

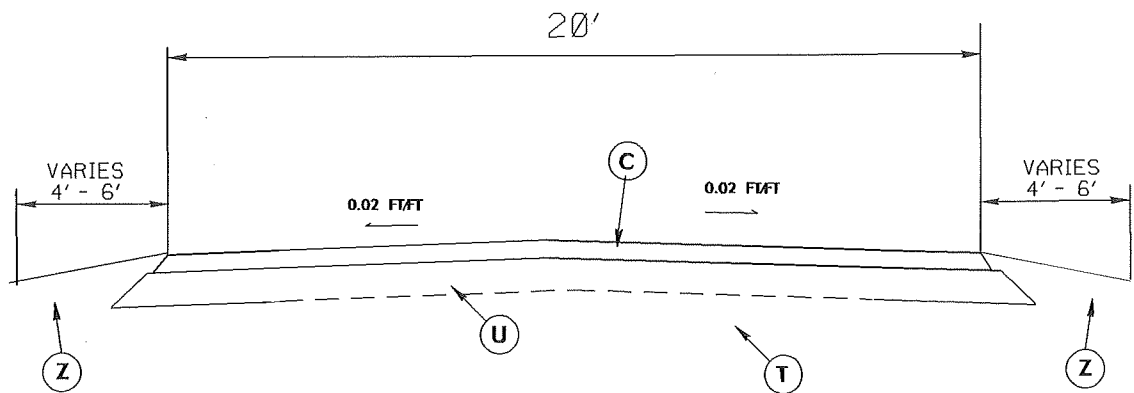

TYPICAL SECTION NO. 4

USE ON SR 1226 FROM STATION 35+90 TO END SYSTEM

TYPICAL SECTIONS

WBS ELEMENT 38307, 3CR.20671.172,

3C.067076 & 3C.067078

MAP NO. 5

WBS 3CR.20671.172

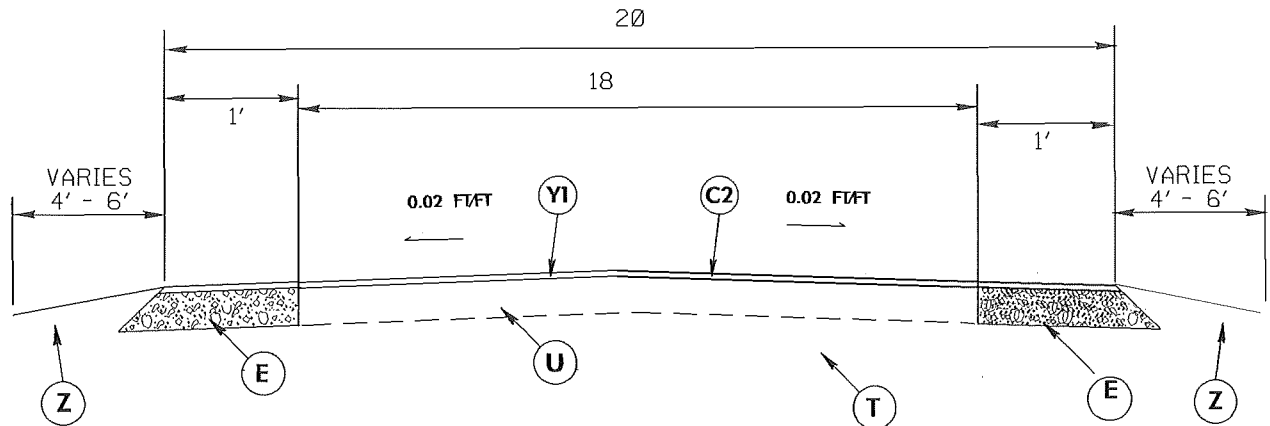

TYPICAL SECTION NO. 5

USE FOR SR 1320
FROM US 258 TO SR 1321

MAP NOS. 6&7

WBS 3C.067076

WBS 3C.067078

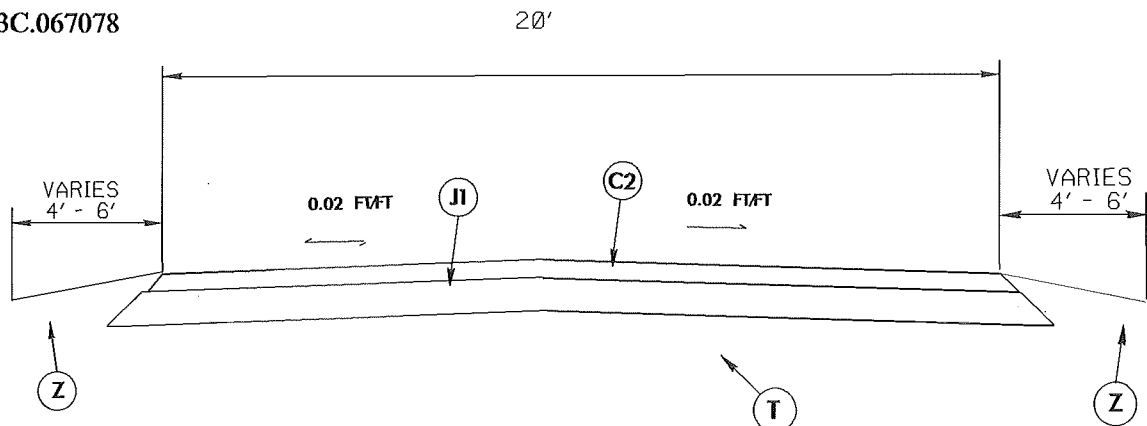

TYPICAL SECTION NO. 6

USE FOR SR 1560 & SR 1938
FROM END MAINTENANCE TO SR 1528
FROM END PAVEMENT TO END MAINTENANCE

PAVEMENT SCHEDULE

WBS ELEMENT 38307, 3CR.20671.172,
3C.067076 & 3C.067078

C	PROP. APPROX. 1" ASPHALT CONCRETE SURFACE COURSE, TYPE SF9.5A, AT AN AVERAGE RATE OF 110 LBS. PER SQ. YD.
C1	PROP. APPROX. 1 1/2" ASPHALT CONCRETE SURFACE COURSE, TYPE SF9.5A, AT AN AVERAGE RATE OF 165 LBS. PER SQ. YD.
C2	PROP. APPROX. 1 1/2" ASPHALT CONCRETE SURFACE COURSE, TYPE S9.5B, AT AN AVERAGE RATE OF 168 LBS. PER SQ. YD.
C3	PROP. APPROX. 2" ASPHALT CONCRETE SURFACE COURSE, TYPE S9.5B, AT AN AVERAGE RATE OF 224 LBS. PER SQ. YD.
C4	PROP. ASPHALT CONCRETE TO TIE TOC TO EXISTING PARKING LOT
E	PROP. APPROX. 4" ASPHALT CONCRETE BASE COURSE, TYPE B25.0B, AT AN AVERAGE RATE OF 456 LBS. PER SQ. YD.
J	PROP. APPROX. 3" AGGREGATE BASE COURSE
J1	EXISTING 6" AGGREGATE BASE COURSE, TO BE CONDITIONED
R	PROP. 2' 6" CONCRETE CURB AND GUTTER
Y	MILL ASPHALT 0.75" DEPTH
Y1	MILL ASPHALT 1.50" DEPTH
Y2	MILL ASPHALT 2" DEPTH
T	EXISTING SUBGRADE MATERIAL
U	EXISTING PAVEMENT
Z	SHOULDER CONSTRUCTION AND /OR RECONSTRUCTION EARTH MATERIAL